

# PC4226D

# Box List

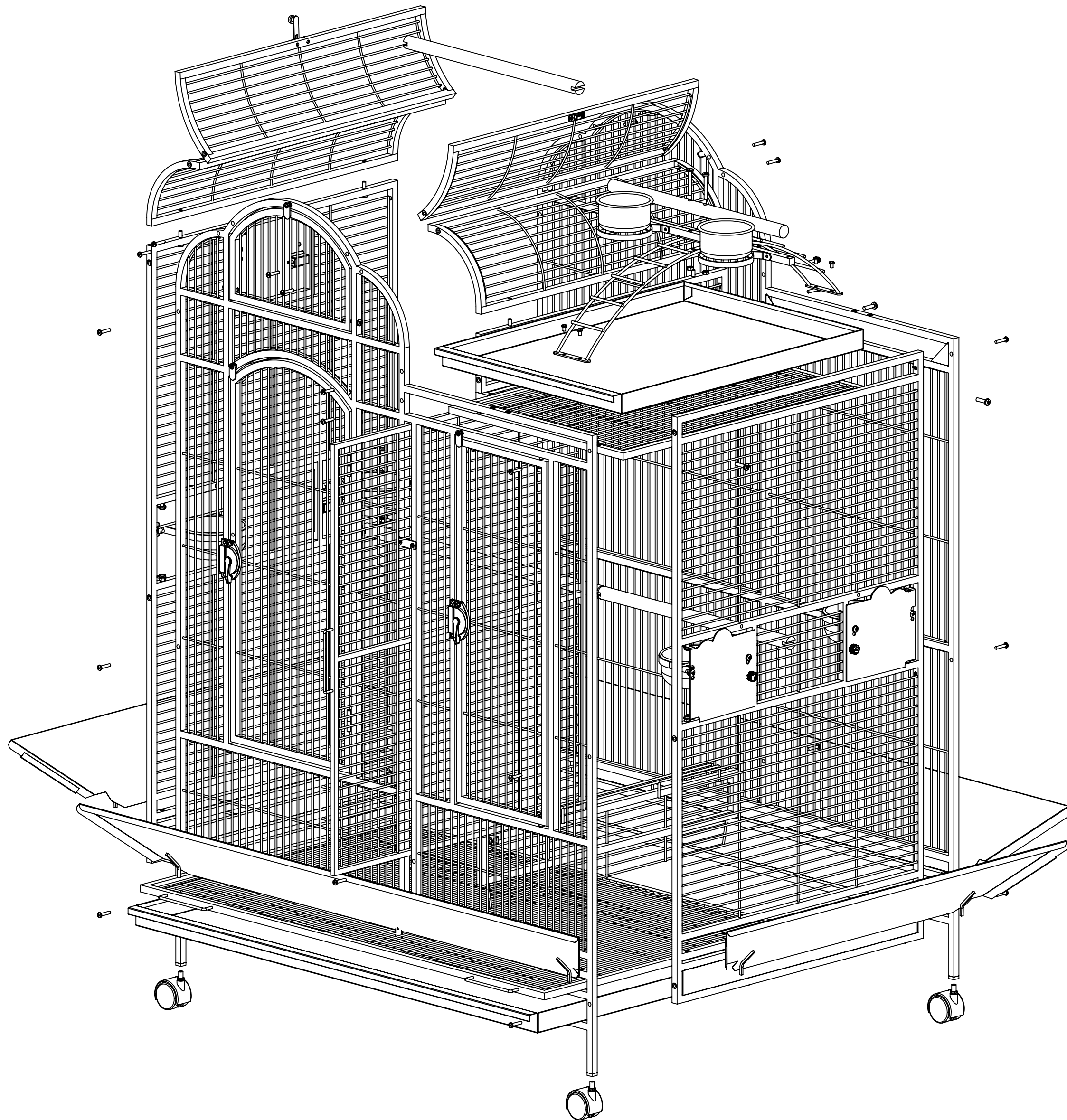

Item No: PC4226D		Worker	Q C	ganger
Box 1/2				
Part name	Quantity			
Front wire(前网)	1pcs			
Back wire(后网)	1pcs			
Upper middle panel(wire)(中上隔网)	1pcs			
Bottom middle panel(wire)(中下隔网)	1pcs			
Top wire(铁线盖网)	1pcs			
Seed guards(裙边)	4pcs			
Assembly Instructions(包装图)	1pcs			
Perch(上下木)	5pcs			
Grill(密网)	1pcs			
Tray(铁盆)	2pcs			
Wheels(2寸8厘米脚轮)	4pcs			
Feeders(5寸杯)	4pcs			
Holder(5寸合圈)	4pcs			
Feeders(4寸杯)	2pcs			
Stairs(支架)	1pcs			
Playtoy tube(支架方管)	1pcs			
Toy hook(No include)(玩具钩)	1pcs			
Screw bag(螺丝包)	1pcs			
Box 2/2		Worker	Q C	ganger
Upper top panel(wire)(上盖网)	2pcs			
Low top panel(wire)(下盖网)	2pcs			
Left right panel(wire)(左右网)	2pcs			
Divider(隔网)	1pcs			

1. Screw 2x wheels onto bottom of front wire then 2x wheels onto bottom of back wire.
2. Attach front 、 back、 left、 right wire together with M5X25 screws.
3. Attach upper middle wire and low middle wire between the front and back wire with M5X25 screws.
4. Attach corner wire on top of left and right wire with screws;
5. Attach upper top wire on the top of the body ;
6. Put the top wire onto top (by right) of body;
7. Assembly stairs and toy hook stand onto the top(by right) of the body;
8. Slide tray and grill into the body ;
9. Open the front door and put perch from left to right inside the body;
10. Open the dish door and put the dish into the holders;
11. Fixup all the screws.