

# PC6928D

## Box List

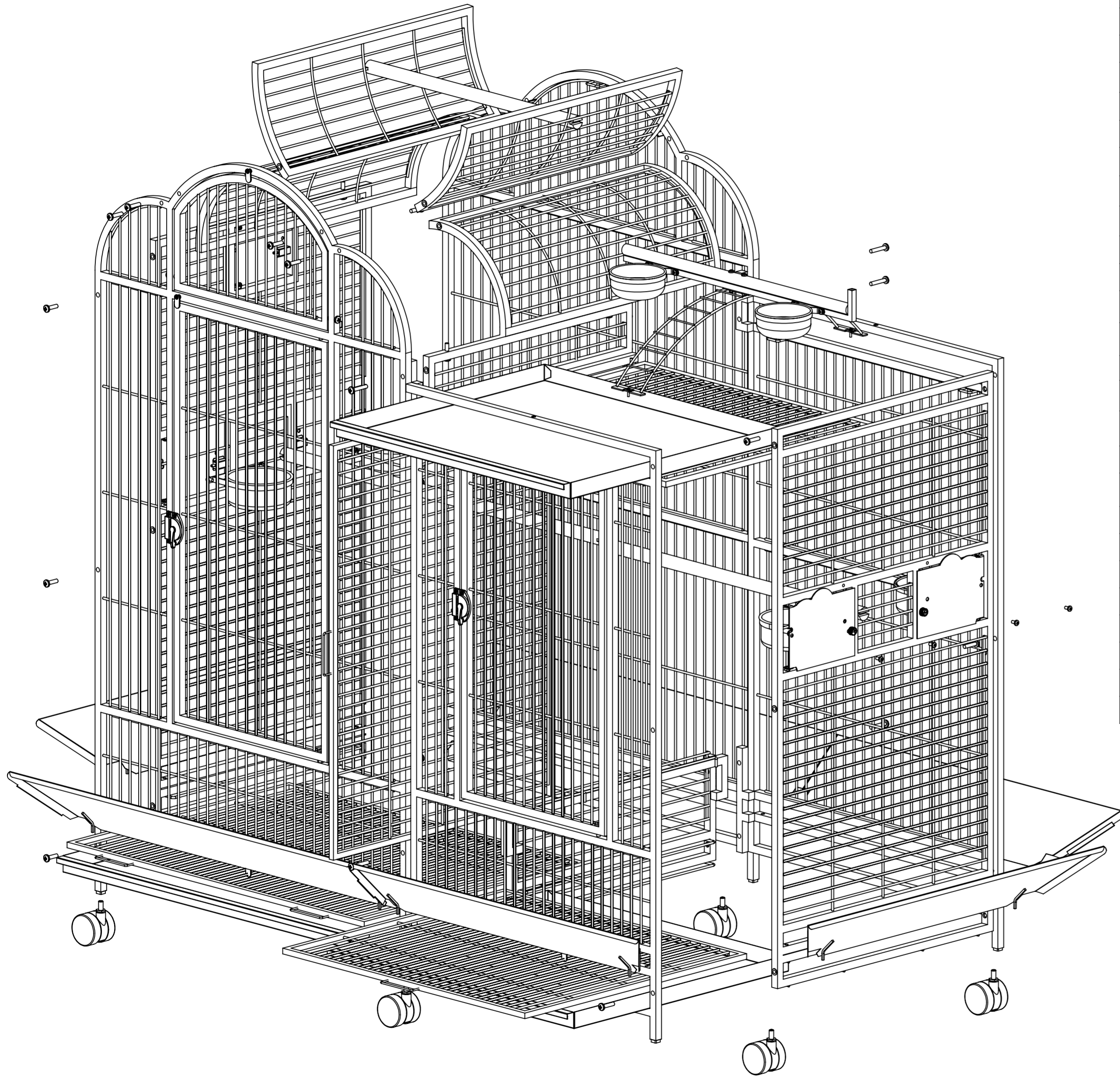

Item No: PC6928D				
Box 1/3		Worker	Q C	ganger
Part name	Quantity			
Big front rear wire(大前后网)	2pcs			
Left right wire(左右网)	2pcs			
Tube(方管)	1pcs			
Seed guards(裙边)	4pcs			
Perch(木棍)	4pcs			
Box 2/3		Worker	Q C	ganger
Small front rear wire(小前后网)	2Pcs			
Divider(隔网)	1Pcs			
Grill(密网)	2pcs			
Top wire(方形盖网)	1pcs			
Middle fram for divider(隔网架)	1pcs			
Box 3/3		Worker	Q C	ganger
Tray(铁盆)	3pcs			
Upper top wire(上盖网)	2pcs			
Bottom top wire(下盖网)	2pcs			
Holder(6寸合圈)	4pcs			
Feeders(6寸杯)	4pcs			
Feeders(4寸杯)	2pcs			
Wheels(3寸12厘脚轮)	6pcs			
Stairs(支架)	1pcs			
Playtop tube(支架方管)	1pcs			
Toy hook (No include)(玩具钩)	1pcs			
Screw bag(螺丝包)	1pcs			

1. Screw 2x wheels onto bottom of 2x big front rear wire then 2x wheels onto bottom of 2x small front rear wire.
2. Attach 2x big front rear wire , 2x small front rear wire, left, right wire together with screws.
3. Attach upper middle wire and low middle wire between the front and back wire with M5X25 screws.
4. Attach corner wire on top of left and right wire with screws;
5. Attach upper top wire on the top of the body ;
6. Put the top wire onto top (by right) of body;
7. Assembly stairs and toy hook stand onto the top(by right) of the body;
8. Slide tray and grill into the body ;
9. Open the front door and put perch from left to right inside the body;
10. Open the dish door and put the dish into the holders;
11. Fixup all the screws.