

702

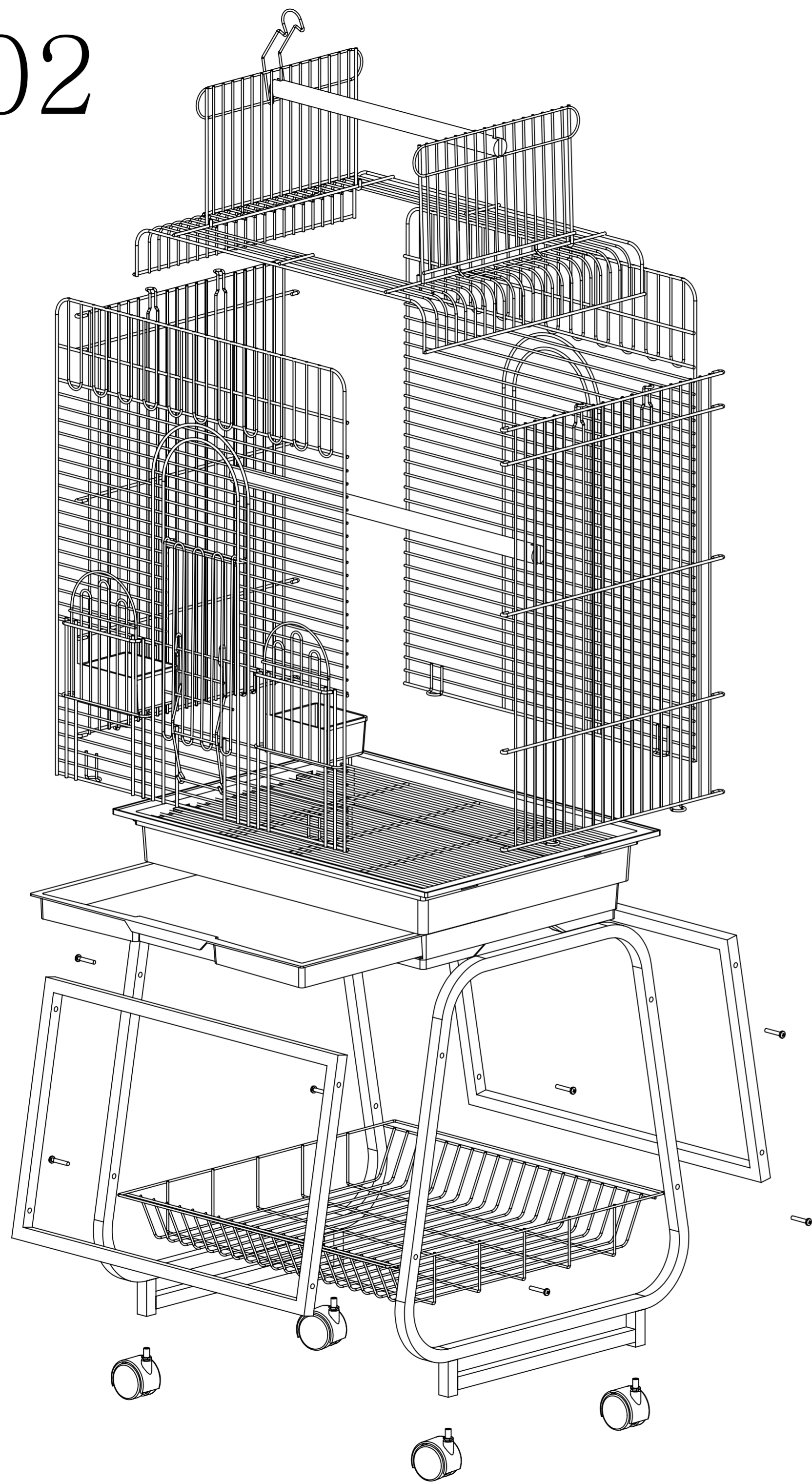

## Box List

Item No:	702			
Box		Worker	Q C	ganger
Part name	Quantity			
Front wire(前网)	1pcs			
Back wire(后网)	1pcs			
Left wire(左网)	1pcs			
Right wire(右网)	1pcs			
Plastic bottom (701胶盘)	1pcs			
Left & right legs (左右脚框)	2pcs			
Front & back legs (前后脚框)	2pcs			
Upper perch(上木棍)	1pcs			
Bottom perch(下木棍)	1pcs			
Grill(密网)	1pcs			
Top wire(盖网)	1pcs			
Bottom grill(脚网)	1pcs			
Plastic cup(701胶杯)	2pcs			
Wheels(2寸8厘脚轮)	4pcs			
Assembly Instructions(包装图)	1pcs			
Screw bag(螺丝包)	1pcs			

1. Screw 2 x wheels onto bottom of left & right legs.
2. Attach left & right legs、front & back frame together with screws to form a stand.
3. Put wire basket on bottom of the stand.
4. Put plastic bottom on top of the stand.
5. Slide plastic drawer in space underneath plastic bottom.
6. Put front, back, left, right wire mesh together to form body.
7. Put bottom wire mesh inside the body on the hitches at bottom.
8. Put 2 x feeder cups inside the feeder doors.
9. Put the perch from left to right inside body.
10. Assembly top wire meshes on top of body.
11. Put the body on the stand from a cage.