

722217

Box List

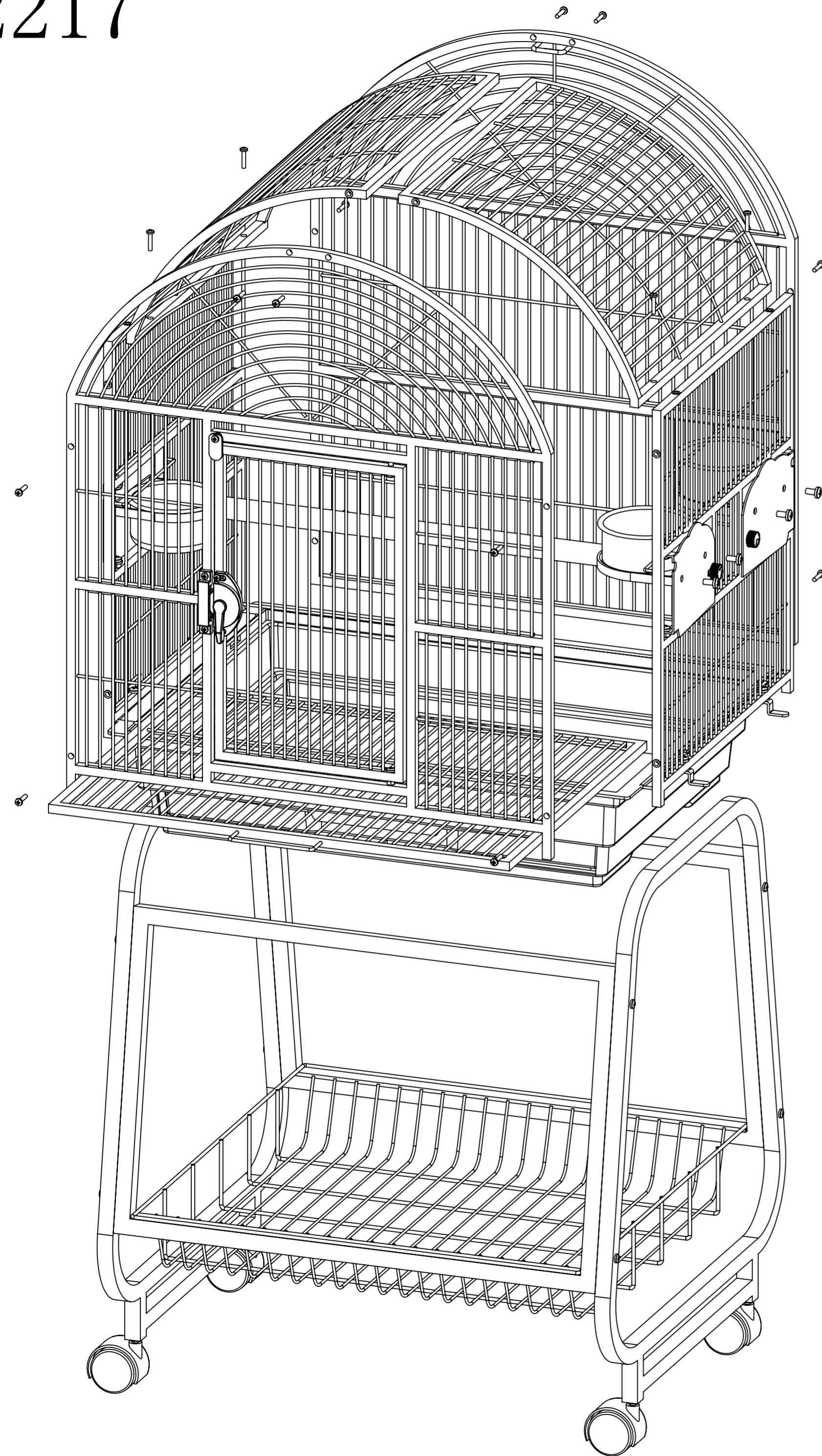

Item No. : 722217				
Box		Worker	Q C	ganger
Part name	Quantity			
Front wire(前网)	1pcs			
Back wire(后网)	1pcs			
Left wire(左网)	1pcs			
Right wire(右网)	1pcs			
Assembly Instructions(包装图)	1pcs			
Bottom perch(下棍)	1pcs			
Front & back frame (前后脚框)	2pcs			
Left & right legs(左右脚框)	2pcs			
Grill(密网)	1pcs			
Bottom grill(脚网)	1pcs			
Top wire(盖网)	2pcs			
Plastic bottom (701胶盆)	1pcs			
Wheels(2寸8厘脚轮)	4pcs			
Feeders(4寸杯)	3pcs			
Holder(4寸合圈)	3pcs			
Screw bag(螺丝包)	1pcs			

1. Screw 2x wheels onto bottom of left & right legs.
2. Attach left & right legs, front & back frame together with screws to form a stand.
3. Put bottom grill on bottom of the stand.
4. Put plastic bottom on top of the stand.
5. Slide plastic drawer in space underneath plastic bottom.
6. Put front wire, back wire, left wire, right wire together with screws ;
7. Attach top wire to the top of the cage body with screw;
8. Slide grill into bottom of the cage;
9. Put the feeder dish into the dish door and the perch into the cage.
10. Put the cage body on the stand from a cage.