

Box List

4020-2FL

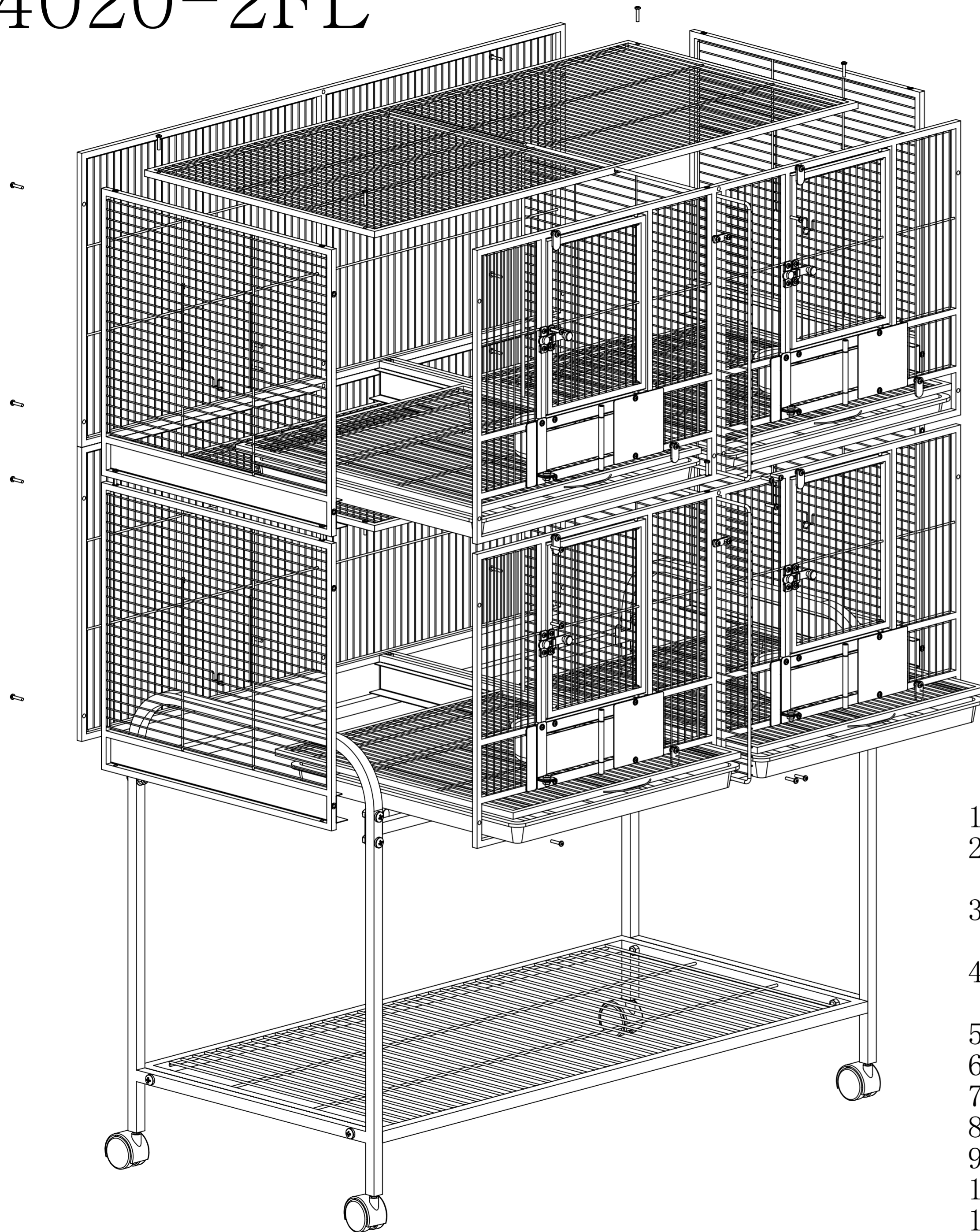

Item No:	4020-2FL			
Box 1/2		Worker	Q C	ganger
Part name	Quantity			
Front wire(前网)	2pcs			
Back wire(后网)	2pcs			
Top wire(盖网)	2pcs			
Bottom grill(脚网)	1pcs			
Plastic bottom(600胶盘)	4pcs			
Tube(方管)	2pcs			
Assembly Instructions(包装图)	1pcs			
Box 2/2		Worker	Q C	ganger
Grill(密网)	4pcs			
Left wire(左网)	2pcs			
Right wire(右网)	2pcs			
Tray guide(导轨)	2pcs			
Divider(隔网)	2pcs			
Perch(木棍)	4pcs			
Left & right leg(左右脚框)	2pcs			
Wheels(2寸8厘米脚轮)	4pcs			
Feeders(4寸不锈钢杯)	8pcs			
Feeder station(喂食站)	4pcs			
Screw bag(螺丝包)	1pcs			

1. Screw wheels onto bottom of left & right legs ;
2. Attach the bottom wire to the left & right legs together with screws;
3. Attach tube to left & right legs with screws to form a stand;
4. Assembly front wire 、 back wire、 left wire and right wire together with screws to form a body;
5. Attach front wire 、 back wire and tray guide with screw;
6. Attach front wire and feeder station with screw;
7. Assembly top wire on top of the body to get the cage A;
8. Repeat step 4 、 step 5 、 step 6 and step 7 to get cage B;
9. Put the cages on the stand and screw them together;
10. Slide grills 、 plastic trays and dividers into the cage;
11. Put feeders into the feeder station, then put the perches in the cage.