

782217

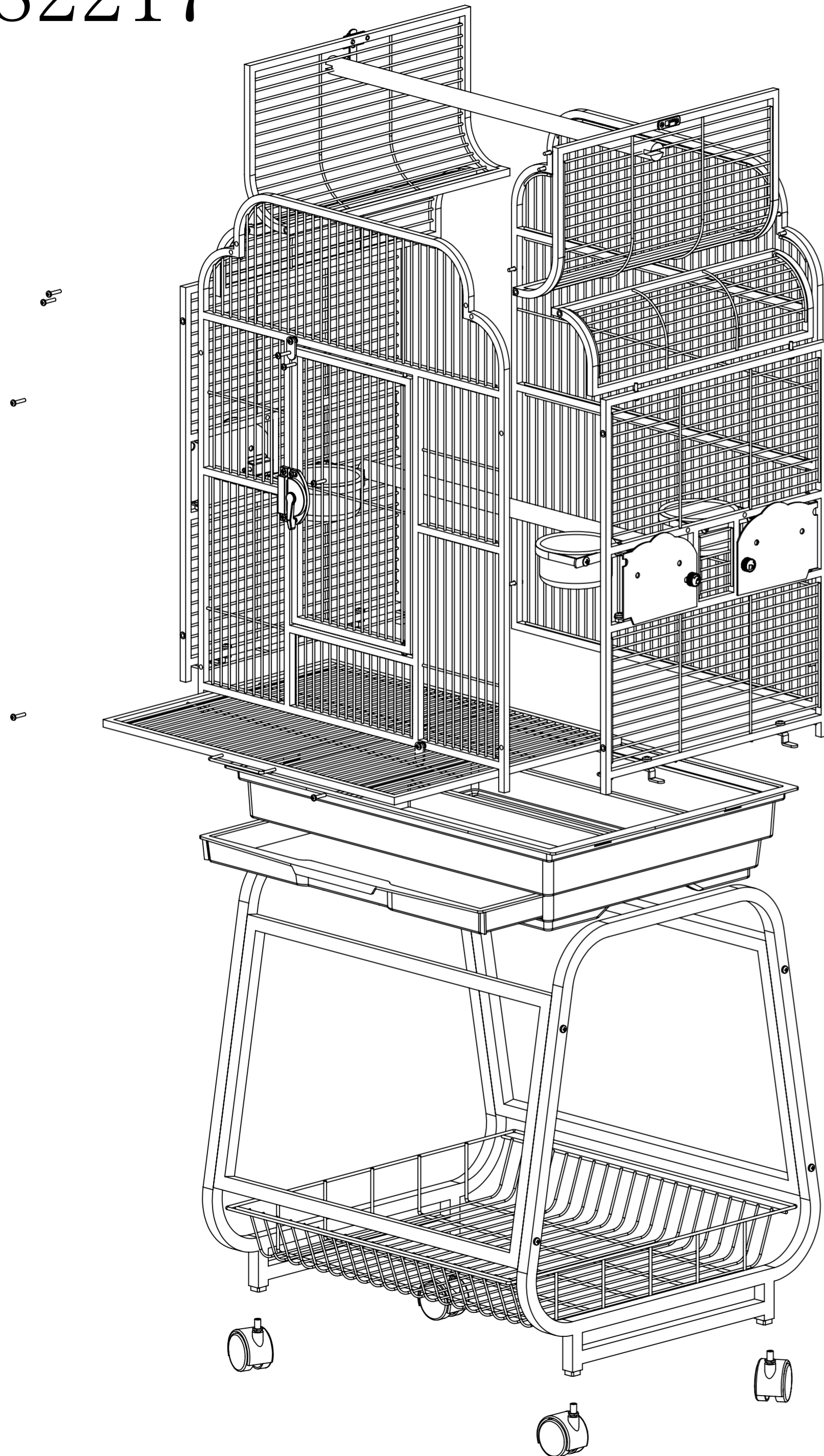

Box List

| Item No: 782217 | | Worker | Q C | ganger |
|----------------------------|----------|--------|-----|--------|
| Box | Quantity | | | |
| Part name | Quantity | | | |
| Front wire(前网) | 1pcs | | | |
| Back wire(后网) | 1pcs | | | |
| Left wire(左网) | 1pcs | | | |
| Right wire(右网) | 1pcs | | | |
| Assembly Instructions(包装图) | 1pcs | | | |
| Upper perch(上棍) | 1pcs | | | |
| Bottom perch(下棍) | 1pcs | | | |
| Front & back frame(前后脚框) | 2pcs | | | |
| Left & right legs(左右脚框) | 2pcs | | | |
| Grill(密网) | 1pcs | | | |
| Bottom grill(脚网) | 1pcs | | | |
| Upper top wire(上盖网) | 2pcs | | | |
| Low top wire(下盖网) | 2pcs | | | |
| Plastic bottom (701胶盆) | 1pcs | | | |
| Wheels(2寸8厘脚轮) | 4pcs | | | |
| Feeders(4寸杯) | 3pcs | | | |
| Holder(4寸合圈) | 3pcs | | | |
| Screw bag(螺丝包) | 1pcs | | | |

1. Screw 2x wheels onto bottom of left & right legs.
2. Attach left & right legs, front & back frame together with screws to form a stand.
3. Put wire basket on bottom of the stand.
4. Put plastic bottom on top of the stand.
5. Slide plastic drawer in space underneath plastic bottom.
6. Put front, back, left, right wire mesh together to form body.
7. Assembly corner wire on top of left and right wire with screws;
8. Assembly top wire on the top of the body to get a cage;
9. Slide grill into bottom of the cage;
10. Put the feeder dish into the dish door and the perches into the cage.
11. Put the perch from left to right inside body.
12. Put the body on the stand from a cage.