

732217

Box List

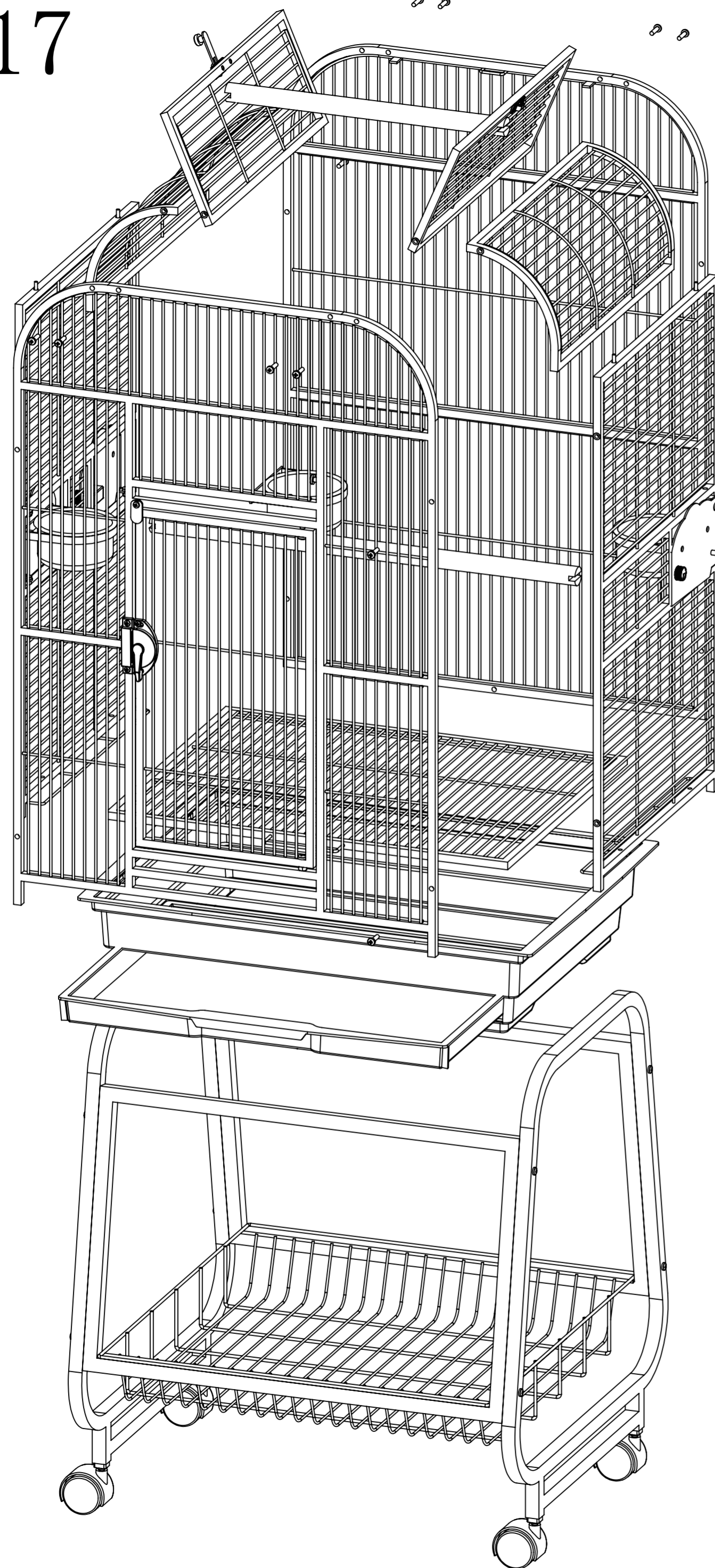

Item No: 732217		Worker	Q C	ganger
Box				
Part name	Quantity			
Front wire(前网)	1pcs			
Back wire(后网)	1pcs			
Left wire(左网)	1pcs			
Right wire(右网)	1pcs			
Assembly Instructions(包装图)	1pcs			
Upper perch(上棍)	1pcs			
Bottom perch(下棍)	1pcs			
Front & back legs(前后脚框)	2pcs			
Left & right legs(左右脚框)	2pcs			
Grill(密网)	1pcs			
Bottom grill(脚网)	1pcs			
Upper top wire(上盖网)	2pcs			
Low top wire(下盖网)	2pcs			
Plastic bottom (701胶盆)	1pcs			
Wheels(2寸8厘脚轮)	4pcs			
Feeders(4寸杯)	3pcs			
Holder(4寸合圈)	3pcs			
Screw bag(螺丝包)	1pcs			

1. Screw 2x wheels onto bottom of left & right legs.
2. Attach left & right legs、front & back frame together with screws to form a stand.
3. Put wire basket on bottom of the stand.
4. Put plastic bottom on top of the stand.
5. Slide plastic drawer in space underneath plastic bottom.
6. Put front, back, left, right wire mesh together to form body.
7. Assembly corner wire on top of left and right wire with screws;
8. Assembly top wire on the top of the body to get a cage;
9. Slide grill into bottom of the cage;
10. Put the feeder dish into the dish door and the perches into the cage.
11. Put the perch from left to right inside body.
12. Put the body on the stand from a cage.