

9004030

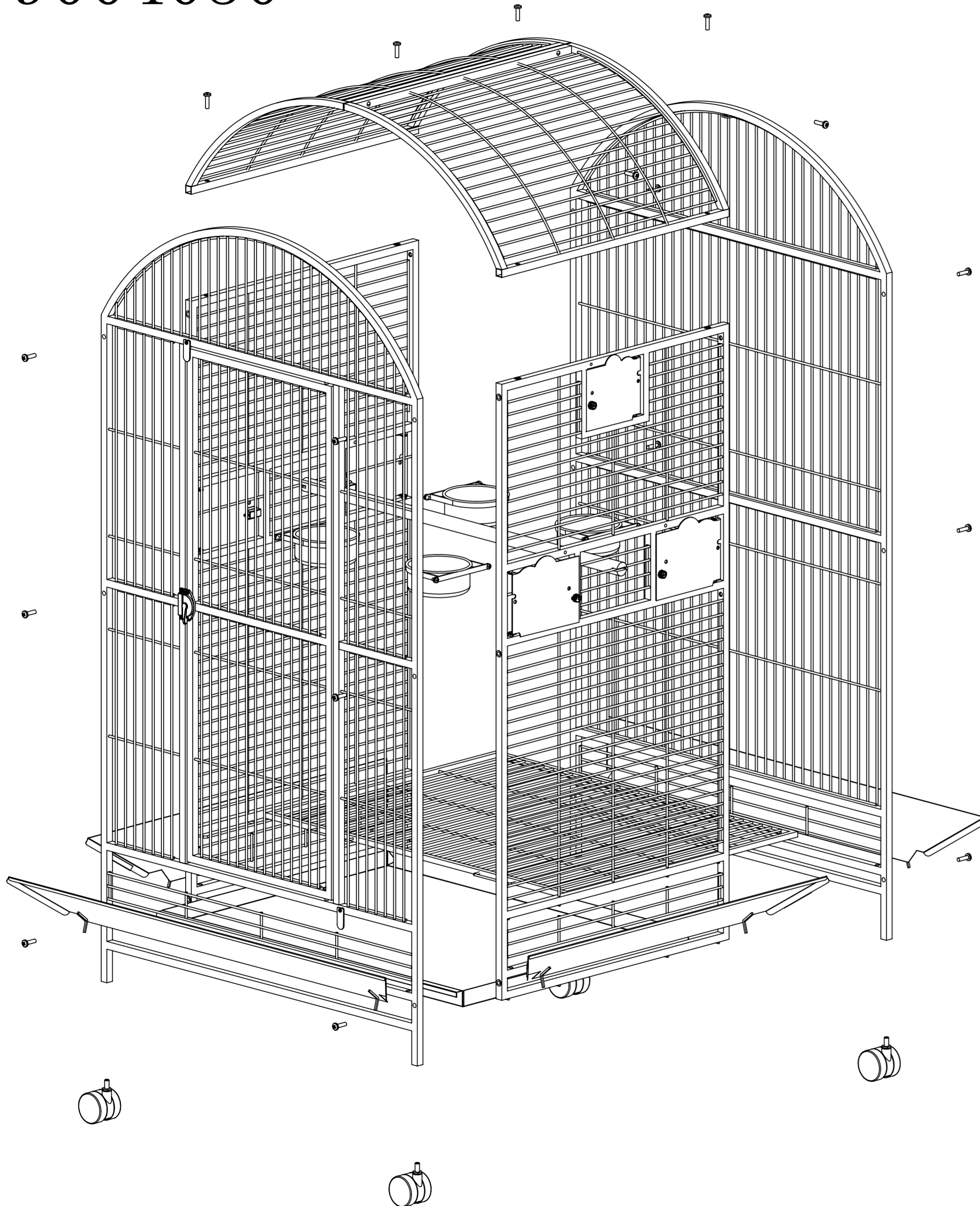

Box List

| | | | | |
|----------------------------|----------|--------|-----|--------|
| Item No: 9004030 | | | | |
| Box 1/2 | | Worker | Q C | ganger |
| Part name | Quantity | | | |
| Front wire(前网) | 1pcs | | | |
| Back wire(后网) | 1pcs | | | |
| Left wire(左网) | 1pcs | | | |
| Right wire(右网) | 1pcs | | | |
| Seed guards(裙边) | 4pcs | | | |
| Assembly Instructions(包装图) | 1pcs | | | |
| Perch(木棍) | 1pcs | | | |
| | | | | |
| Box 2/2 | | Worker | Q C | ganger |
| Grill(密网) | 1pcs | | | |
| Top wire(盖网) | 2pcs | | | |
| Tray(铁盆) | 1pcs | | | |
| Wheels(3寸12厘脚轮) | 4pcs | | | |
| Feeders(6寸杯) | 4pcs | | | |
| Holder(6寸合圈) | 4pcs | | | |
| Screw bag(螺丝包) | 1pcs | | | |

1. Screw 2 x wheels onto bottom of front wire then 2 x wheels onto bottom of back wire.
2. Attach front 、 back、 left、 right wire together with M8X35 screws.
3. Assembly top wire (2 x top wire meshes) on top of the body with M8X35 screws.
4. Slide grill in space underneath the front door.
5. Put 4x seed guards in place above bar around the body.
6. Slide tray in space underneath front seed guard .
7. Screw 4 x door feeders on inside of 4 x doors.
8. Open the front door and put perch from left to right inside the body.