

MA3221FL

Box List

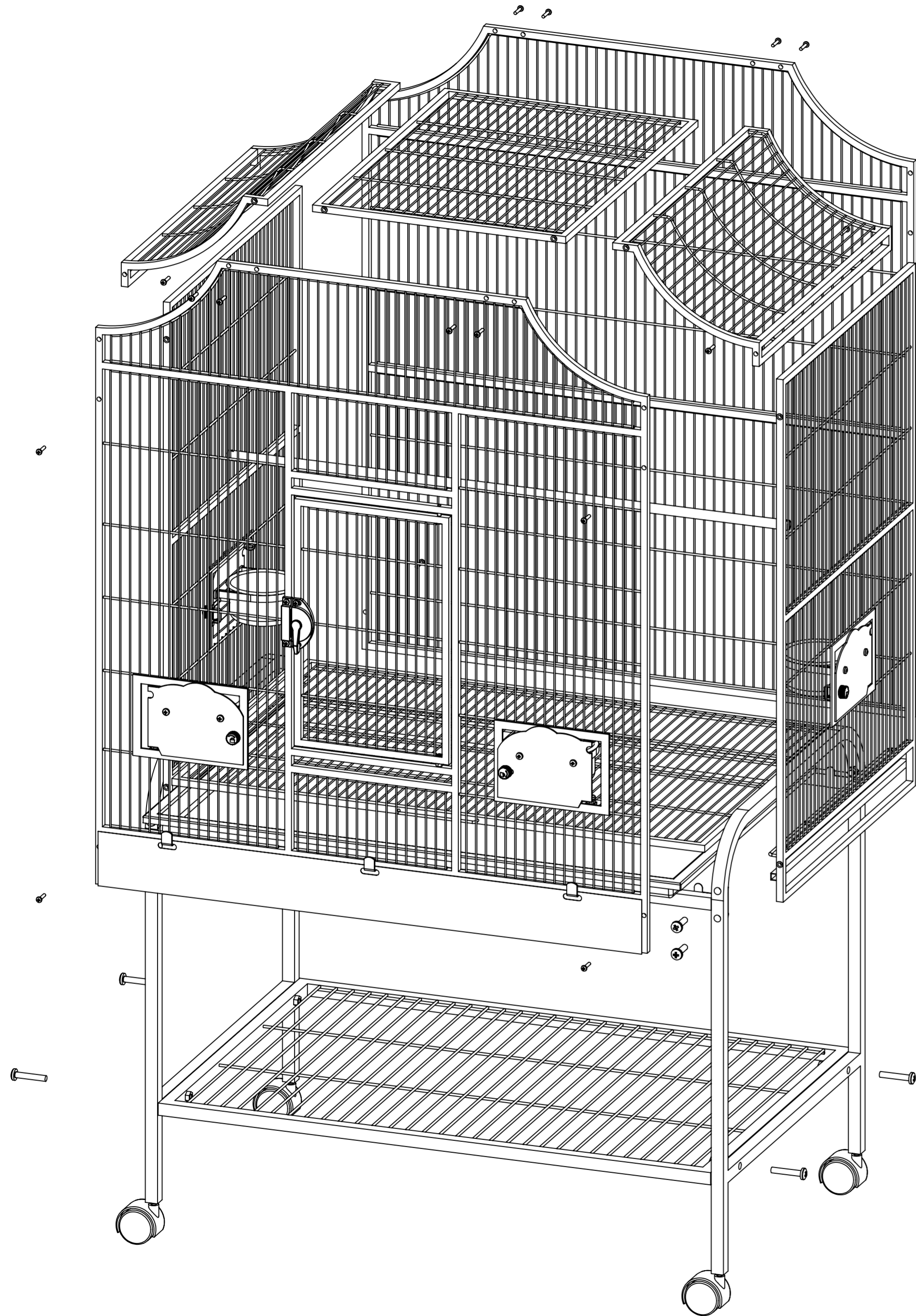

Item No:	MA3221FL			
Box		Worker	Q C	ganger
Part name	Quantity			
Front wire(前网)	1pcs			
Back wire(后网)	1pcs			
Left wire(左网)	1pcs			
Right wire(右网)	1pcs			
Legs(脚框)	2pcs			
Horizontal tube(横管)	2pcs			
Grill(密网)	1pcs			
Upper top panel(wire)(上盖网)	1pcs			
Low top panel(wire)(上盖网)	2pcs			
Bottom wire(脚网)	1pcs			
Baffle(挡板)	1pcs			
Plastic bottom(胶盆)	1pcs			
Wooden perch(木棍)	1pcs			
Wheels(2寸8厘脚轮)	4pcs			
Feeders(4寸杯)	4pcs			
Holder(4寸合圈)	4pcs			
Assembly Instructions(包装图)	1pcs			
Screw bag(螺丝包)	1pcs			

1. Screw wheels onto bottom of left & right legs ;
2. Attach the bottom wire to the left & right legs together with screws;
3. Attach tube to left & right legs with screws to form a stand;
4. Attach front、back、left、right wire together with screws;
5. Attach lower top wire to the top of left wire and right wire with screws;
6. Attach upper top wire to the cage body with screws;
7. Screw cup holders to feeder door and put the feeders into the holders, then put the perches into the cage body;
8. Put the body on the stand ;
9. Slide the grill、plastic bottom into the cage body;
10. Put the boffle to hang front wire.