

CC4242

Box List

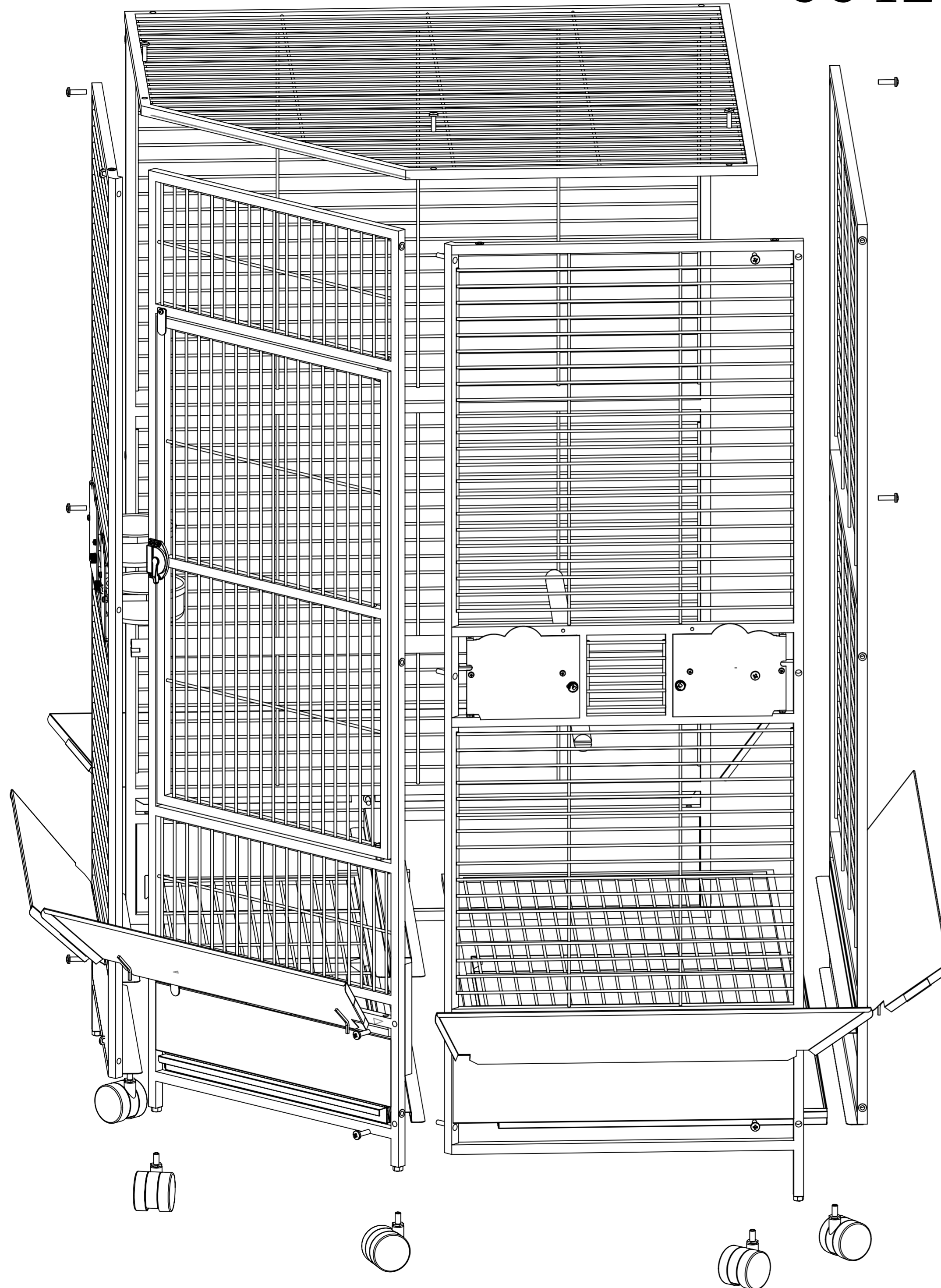

Item No: CC4242				
Box 1/3		Worker	Q C	ganger
Part name	Quantity			
Back wire (后网)	2pcs			
Top wire (盖网)	1pcs			
Seed guards(裙边)	5pcs			
Assembly Instructions(包装图)	1pcs			
Box 2/3		Worker	Q C	ganger
Left wire (左网)	1Pcs			
Right wire (右网)	1Pcs			
Front wire (前网)	1pcs			
Box 3/3		Worker	Q C	ganger
Tray(铁盆)	2pcs			
Grill(密网)	2pcs			
Holder(6寸合圈)	4pcs			
Feeders(6寸不锈钢杯)	4pcs			
Perch(木棍)	2pcs			
Wheels(3寸12厘脚轮)	5pcs			
Tray guide(拉盘槽)	1pcs			
Screw bag(螺丝包)	1pcs			

1. Screw wheels onto bottom of front、back(with leg)、left 、right wire .
2. Attach front 、back、left、right wire together with M8X35 screws.
3. Screw tray guide into the inner cage;
4. Insert seed guard into the hole of body and attach themsleves with screws;
5. Assembly top wire on top of body, then you get a cage;
6. Slide grill 、 tray 、 grill 、 tray into the cage;
7. Put the feeder dish into the dish door;
8. Put the perches onto the cage as you will;
9. Tighten all the screws.